



# 300W Single output DC/DC power supply

SD Series

- High efficiency, long service life and high reliability
- output protection function: Over current/short circuit
- ultra wide operating temperature range-20°C~60°C
- long service life electrolytic capacitor
- 100% full load ageing test
- no fan, quiet
- 3 years



MODEL		SD-300B-12	SD-300C-12	SD-300B-24	SD-300C-24	SD-300B-48	SD-300C-48
OUTPUT	DC Output	12V		24V		48V	
	Rated Current	25A		24A		6.3A	
	Current Range	0~25A		0~24A		0~6.3A	
	Ripple and Noise	100mV		200mV		200mV	
	Voltage ADJ. Range	±10% of rated output voltage					
	Voltage Accuracy	±2.0%		±1.0%		±1.0%	
	Line Regulation	±0.5%		±0.3%		±0.2%	
	Load Regulation	±0.5%		±0.3%		±0.2%	
	Set-up Time	< 1S					
	Hold up Time	< 50ms					
INPUT	Voltage Range	B:20 ~ 36VDC C:36 ~ 72VDC					
	Frequency Range	47Hz~63Hz					
	Efficiency	80%	81%	80%	81%	84%	82%
PROTECTION	Over Load	105%~150% of rated output current, hiccup mode, auto recovery					
	Over power	120%~135% of rated output current, hiccup mode, auto recovery					
	Short Circuit	Long-term mode, auto recovery					
ENVIRONMENT	Operating amb. Temp. & Hum.	-20°C~60°C; 20%~90%RH					
	Storage Temp. & Hum.	-40°C~85°C; 10%~95%RH					
SAFETY & EMC	Safety Standards	Reference LVD design, TUV EN62368-1					
	Withstand Voltage	I/P-O/P:1.5KVAC I/P-FG:2.0KVAC O/P-FG:0.5KVAC					
OTHERS	MTBF (MIL-HDBK-217F)	More than 100,000Hrs (25°C, Full load)					
	Dimension (L*W*H)	215*115*50mm					
	Packing	1200g/PCS					
	Cooling method	Cooling by free air convection					
NOTE	1.All parameters NOT specially mentioned are measured at rated input, rated load and 25°C of ambient temperature.						

Block diagram of internal mechanism





Block diagram of internal mechanism

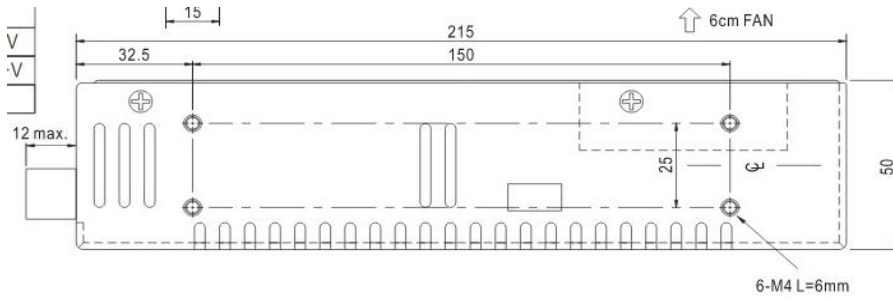
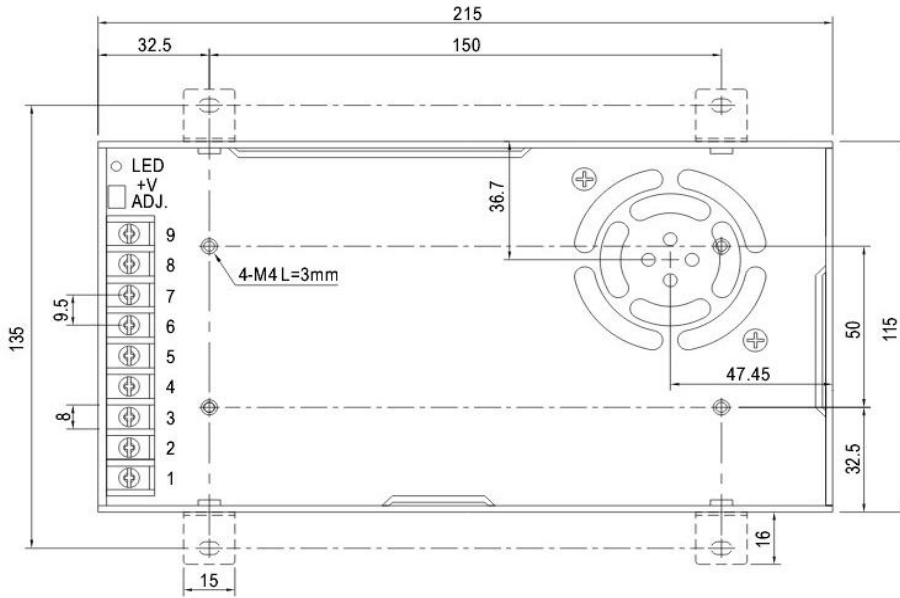

Declining curve:

